

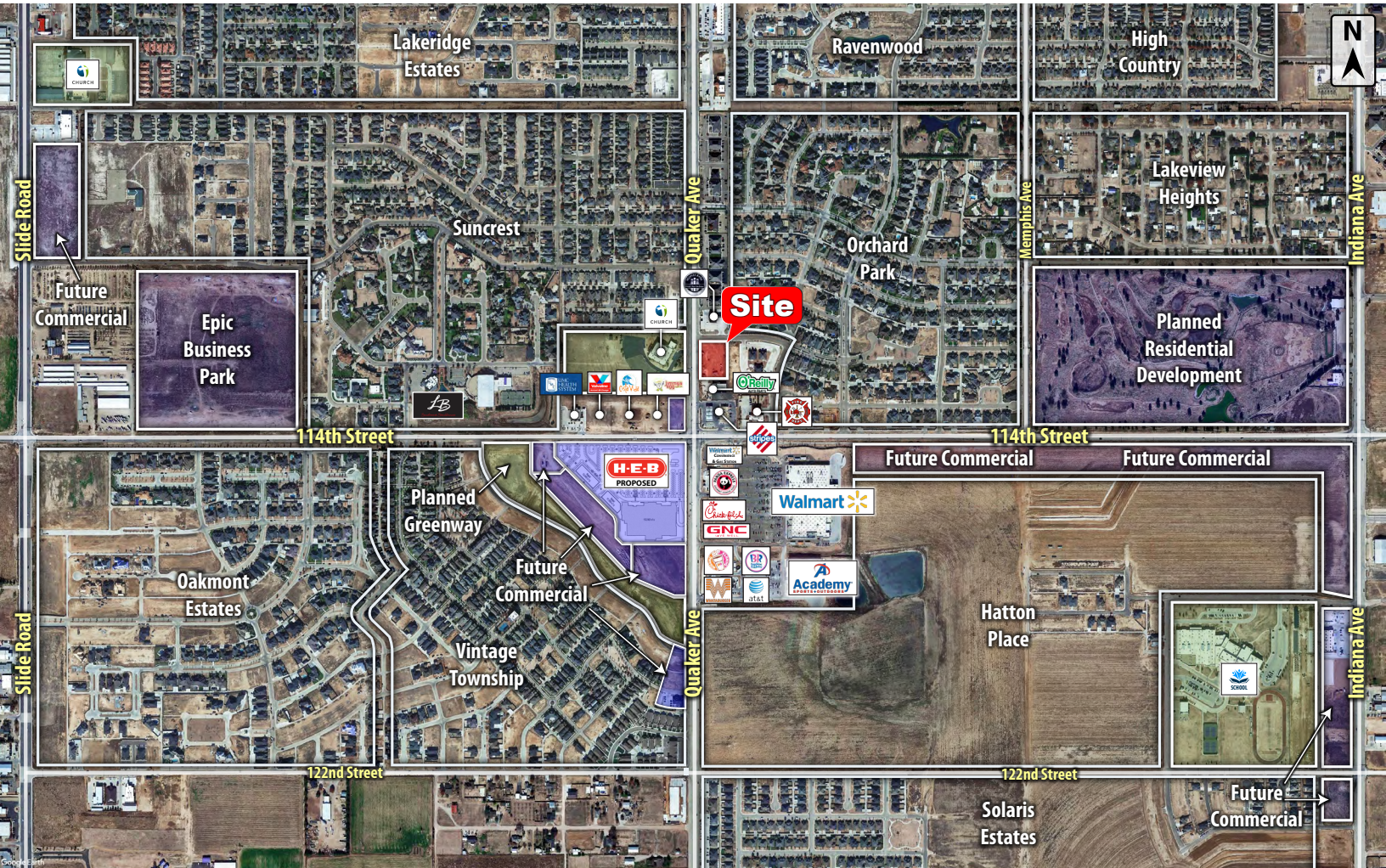

## 112th Street & Quaker Avenue

Lubbock, TX 79423

LAND



## QUICK FACTS



PURCHASE PRICE

**Ground Lease  
or Build-to-Suit**

[CBCWORLDWIDE.COM](http://CBCWORLDWIDE.COM)



TOTAL ACREAGE

**1.64 Acres**



ZONING

**Commercial**



TRAFFIC COUNT

**17,000+ VPD**

Beau Tucker, CCIM  
806.470.3944  
[BTucker@CBCWorldwide.com](mailto:BTucker@CBCWorldwide.com)



**COLDWELL  
BANKER  
COMMERCIAL**

**CAPITAL ADVISORS**





## Trade Area & Information



## LOCATION

Located in south Lubbock at the southeast corner of 112th Street & Quaker Avenue.

## DESCRIPTION

This tract is in a quickly developing area of south Lubbock. A \$7.75 million 7-lane thoroughfare expansion has been completed on Quaker Avenue from 98th Street to FM 1585. United Supermarkets, Academy, and a planned HEB will anchor this intersection.

Property is not in the floodplain.

## PRICING

1.64 Acres - Ground Lease or Build-to-Suit



**COLDWELL  
BANKER  
COMMERCIAL**

CAPITAL ADVISORS





## Demographics



### POPULATION

	1 MILE	3 MILES	5 MILES
TOTAL POPULATION	3,548*	37,877	116,572
MEDIAN AGE	40.9	40.0	39.0
MEDIAN AGE (MALE)	40.4	39.2	37.9
MEDIAN AGE (FEMALE)	41.4	40.8	40.0

### HOUSEHOLDS & INCOME

	1 MILE	3 MILES	5 MILES
TOTAL HOUSEHOLDS	1,453*	15,896	48,210
# OF PERSONS PER HH	2.5	2.4	2.4
AVERAGE HH INCOME	\$116,785	\$92,052	\$69,463
AVERAGE HOUSE VALUE	\$165,502*	\$155,323	\$149,085

\* is an estimated number

CBCWORLDWIDE.COM

Beau Tucker, CCIM  
806.470.3944  
BTucker@CBCWorldwide.com

©2019 Coldwell Banker Real Estate LLC, dba Coldwell Banker Commercial Capital Advisors. All rights reserved. Coldwell Banker Commercial® and the Coldwell Banker Commercial are registered service marks owned by Coldwell Banker Real Estate LLC. Coldwell Banker Real Estate LLC, dba Coldwell Banker Commercial Affiliates fully supports the principles of the Fair Housing Act and the Equal Opportunity Act. Each office is independently owned and operated. The information provided is deemed reliable, but it is not guaranteed to be accurate or complete, and it should not be relied upon as such. This information should be independently verified before any person enters into a transaction based upon it.



**COLDWELL  
BANKER  
COMMERCIAL**

**CAPITAL ADVISORS**